

# PROBLEM VENUE LOCATIONS

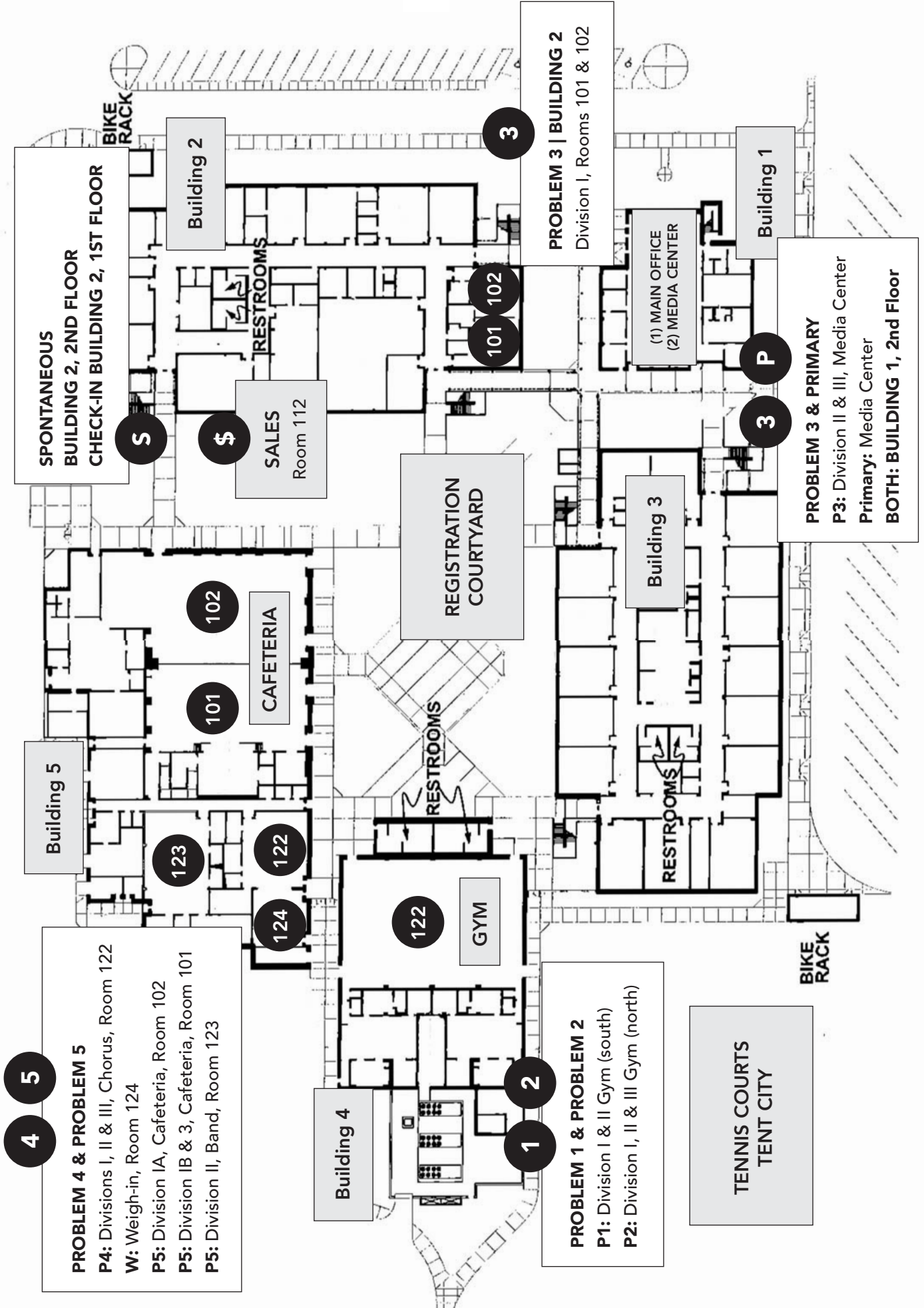

4 5

**PROBLEM 4 & PROBLEM 5**  
**P4:** Divisions I, II & III, Chorus, Room 122  
**W:** Weigh-in, Room 124  
**P5:** Division IA, Cafeteria, Room 102  
**P5:** Division IB & 3, Cafeteria, Room 101  
**P5:** Division II, Band, Room 123

**SPONTANEOUS**  
**BUILDING 2, 2ND FLOOR**  
**CHECK-IN BUILDING 2, 1ST FLOOR**

S

\$

**SALES**  
 Room 112

102

101

**CAFETERIA**

123

122

124

122

**GYM**

1

2

**PROBLEM 1 & PROBLEM 2**  
**P1:** Division I & II Gym (south)  
**P2:** Division I, II & III Gym (north)

**Building 4**

**REGISTRATION**  
**COURTYARD**

**RESTROOMS**

**Building 3**

**RESTROOMS**

101

102

3

**PROBLEM 3 | BUILDING 2**  
 Division I, Rooms 101 & 102

(1) MAIN OFFICE  
 (2) MEDIA CENTER

**TENNIS COURTS**  
**TENT CITY**

3

P

3

**PROBLEM 3 & PRIMARY**  
**P3:** Division II & III, Media Center  
**Primary:** Media Center  
**BOTH: BUILDING 1, 2nd Floor**

**Building 1**

**BIKE RACK**

**BIKE RACK**